

NOTES:

1. FLOOD HAZARD AREAS, FLOOD EXTENTS AND FLOODWAY HAVE BEEN CALCULATED AT CROSS SECTIONS ONLY.
2. FLOOD HAZARD AREAS, FLOOD EXTENTS AND FLOODWAY BETWEEN CROSS SECTIONS HAVE BEEN LINEARLY INTERPOLATED.
3. FLOOD EXTENTS DEPICT APPROXIMATE WIDTHS OF FLOODING ONLY. FLOOD LIABILITY SHOULD BE VERIFIED BY GROUND SURVEY.

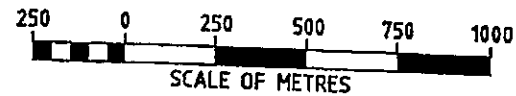

LEGEND:

- 1% AEP FLOOD EXTENT
- LIMIT OF HIGH HAZARD
- LIMIT OF FLOODWAY
- - - - - LEVEE
- CROSS SECTIONS
- [Dotted pattern] LOW HAZARD: THOSE AREAS WHERE FLOOD CONDITIONS WOULD NOT PRESENT UNLIE DIFFICULTY OR DANGER DURING EVACUATION.
- [Dotted pattern] HIGH HAZARD: THOSE AREAS WHERE FLOOD CONDITIONS COULD CAUSE STRUCTURAL DAMAGE TO BUILDINGS AND COULD MAKE EVACUATION DIFFICULT AND DANGEROUS.
- [Dotted pattern] FLOODWAY: THOSE AREAS WHERE A SIGNIFICANT VOLUME OF WATER FLOWS DURING FLOODS. THE EXTENT OF THE FLOODWAY IS DEFINED BY VELOCITY DEPTH CRITERIA: VELOCITY x DEPTH > 1M
- [Box with 1(c)] RURAL SMALL HOLDINGS (LEP 1993)
- [Box with 2(v)] RESIDENTIAL VILLAGE OR URBAN (LEP 1993)

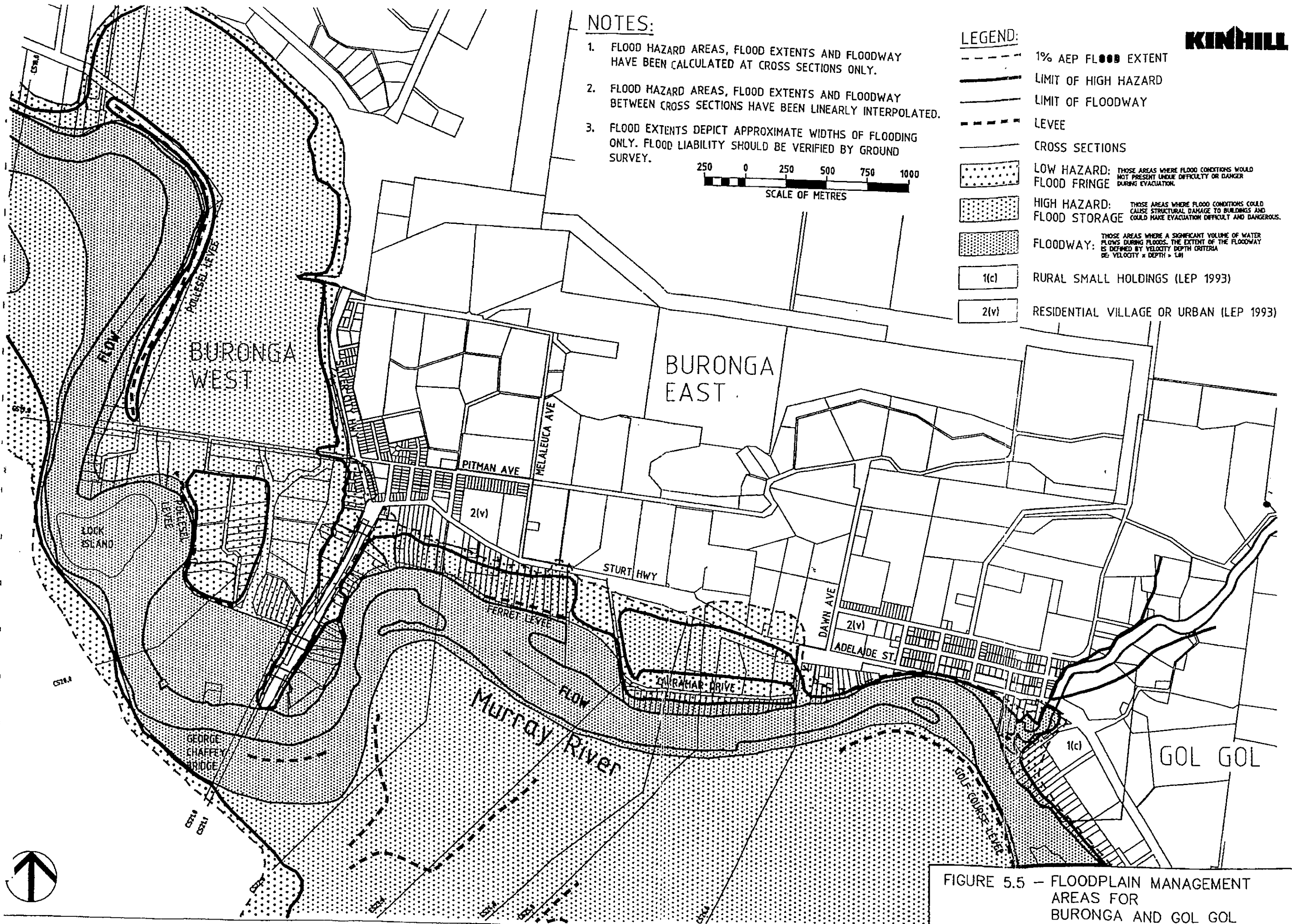

FIGURE 5.5 - FLOODPLAIN MANAGEMENT AREAS FOR BURONGA AND GOL GOL